

# P-1500

## Commercial air conditioner Pressure sensor

- Industry leading accuracy over broad temperature range
- Survives High Vibration
- EMC/ESD performance
- Integrated connector or flying leads
- Flexible threaded fitting or braze tube

TYPICAL APPLICATIONS

- Transport refrigeration
- Chillers
- Commercial refrigeration
- Variable speed HVAC
- Heat pumps

P-1500 series a sensor that measures refrigerant pressure in air conditioning systems. The accuracy of this sensor is essential. These sensors are suitable for special air conditioning, refrigeration and industrial applications where the reliability of air conditioning systems is required.



Characteristic	General SPEC
Output	0.5 to 2.5VDC / 0.5 to 3.5VDC / 0.5 to 4.5VDC / 4~20mA
Inputs	5VDC / 8~32VDC
Operating Temperature	-40°C to 125°C
Pressure Ranges	0 to 2MPa through 0 to 5MPa
Operating Temperature	-40°C to +125°C
Storage Temperature	-40°C to +135°C
Accuracy	± 1% F.S. typical over (-25°C to 125°C)
Treads	1/4" and 1/8" SAE, 1/4" SAE female flare, 3/8" -24UNF, M12x1.5, M10
Supply Current	8mA max @ 5VDC with no load
Output Response Time	1ms
Over Voltage Protection	16VDC
Reverse voltage	-14VDC
Vibration	11g (50 to 2000Hz)
Insulation Resistance (500VDC)	100 MΩ
Pressure Overload	2X Rated
Pressure Burst	3X Rated
EMC	80~1,000MHz : 3V/m
ESD	Air 15KV, Contact 8KV
Wetted Materials	304L Stainless Steel ,Brass/copper, Other materials available
Electrical Connection	IP68 Available
Electrically Isolated Housing	1800VAC for 1 second
Mechanical life cycle	1 million F.S. cycles

Dimensions (mm)

M12 Type

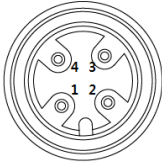
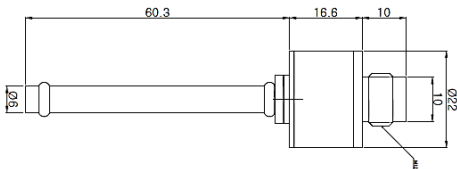

Current			Voltage	
No.	Description	Wire color	No.	Description
1	POWER(+)	Red	1	VDC
2	N.C	-	2	Signal
3	POWER(-)	Black	3	GND
4	N.C	-	4	N.C

Packard Type

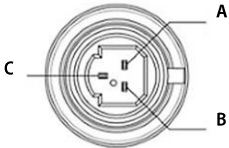
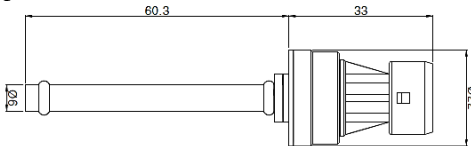

Packard Metripack connector		
No.	Current	Voltage
A	P-	GND
B	P+	VDD
C	SH	OUTPUT

Cable Type

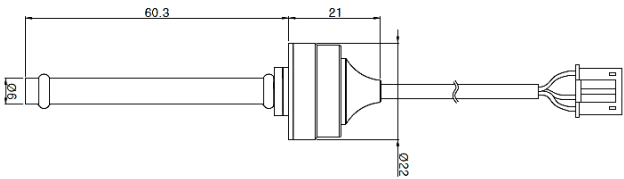

Output signal	Voltage	Current
RED	VDC	Power (+)
GREEN	OUT	-
BLACK	GND	Power (-)

How to order

P - 1500



Type

M12

M

|

|

|

Packard

P

|

|

|

Cable

C

|

|

|

Output signal

0.5 ~ 3.5VDC

-----

V

|

|

0.5 ~ 4.5VDC

-----

VM

|

|

4-20mA

-----

A

|

|

Other request

-----

Z

|

|

Pressure range

0 ~ 2MPa

-----

-----

2M

|

0 ~ 5Mpa

-----

-----

5M

|

Other request

-----

-----

Z

|

Inputs

5 VDC

-----

-----

-----

5V

8~32 VDC

-----

-----

-----

32V